

## > Prime 7000 Flexi



### Passengers and light goods up to 500kg.

Introducing a platform lift with the flexibility to be used for goods and passengers. The Prime 7000 Flexi suits this working environment perfectly, matching the requirements of the passenger whilst allowing goods transportation.

Subject to the client performing a risk assessment, the Prime 7000 Flexi lift is a convenient solution for the carriage of persons, caged trolleys and the carriage of small pallet goods.

To make the user's life easier, the standard specification incorporates features such as a 'send' facility allowing goods to be sent unaccompanied, a 'single touch call' facility to allow you to perform other tasks whilst waiting for the lift to arrive, and an 'overload indicator' to ensure correct loading for the lift.

Compliant with the Equality Act (formerly DDA), yet still allowing use for the carriage of light goods, the dual-purpose nature of the Prime 7000 Flexi matches the requirements of retail and commercial office buildings.

For further information visit [www.gartec.com](http://www.gartec.com).

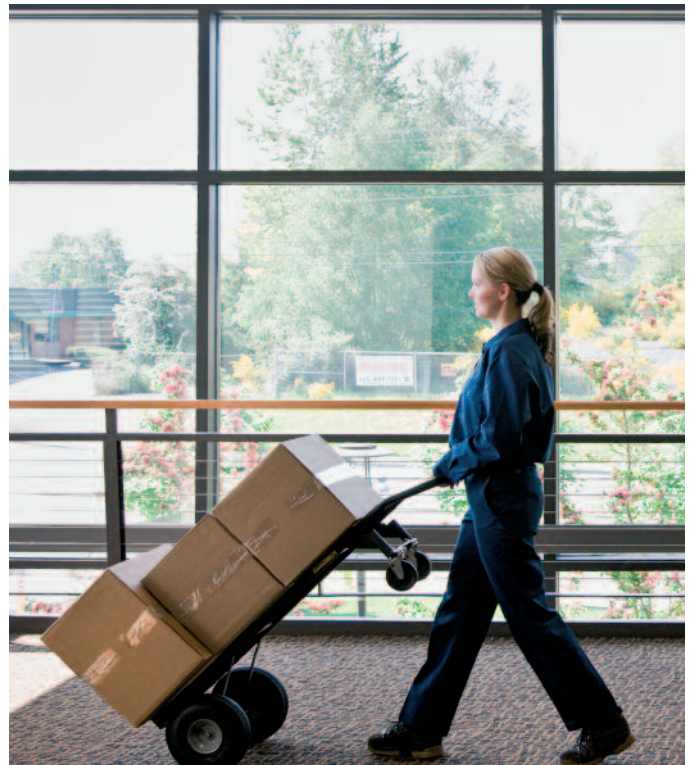

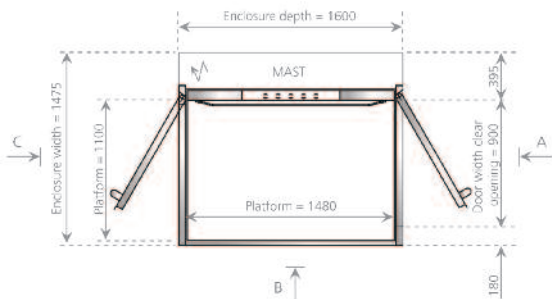
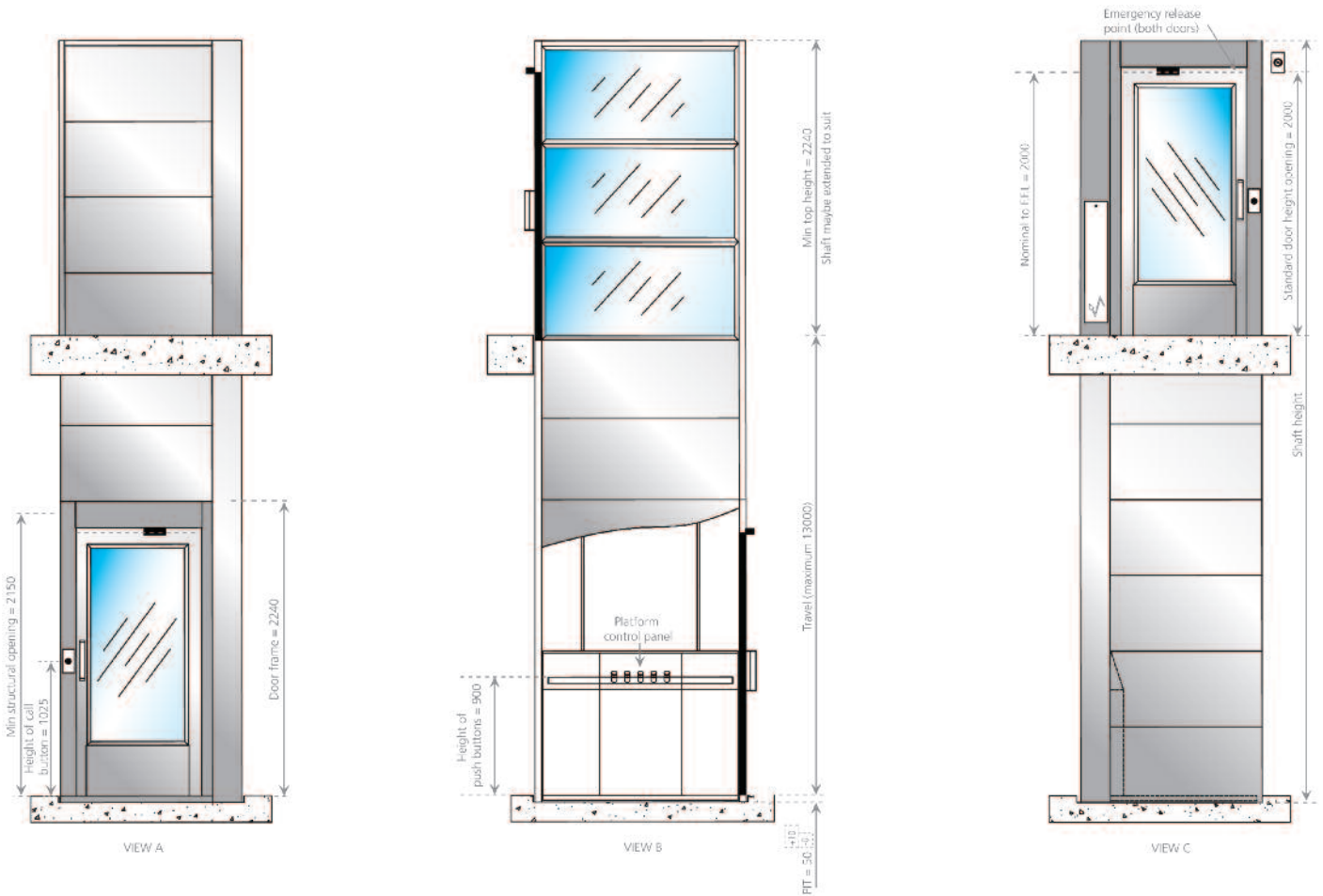

**To further enhance the lift in a goods environment we can also provide the following options:**

- > Steel kerb/bump rail to stop trolleys being pushed against the sidewalls
- > 500kg capacity
- > 1000mm wide opening doors
- > Optional longer platform – 1980mm in length
- > Doors with 'hold open' facility to ensure easier loading

**After-sales Support**

All our lifts are supplied with a 12-month warranty as standard and we offer a range of maintenance and service options which can be tailored to suit your specific requirements.

